



DELTA ELECTRONICS, INC.
www.delta.com.tw/industrialautomation

IABU Headquarters

Delta Electronics, Inc.
Taoyuan1

31-1, Xingbang Road, Guishan Industrial Zone,
Taoyuan County 33370, Taiwan, R.O.C.
TEL: 886-3-362-6301 / FAX: 886-3-362-7267

Asia

Delta Electronics (Jiang Su) Ltd.
Wujiang Plant3

1688 Jiangxing East Road,
Wujiang Economy Development Zone,
Wujiang City, Jiang Su Province,
People's Republic of China (Post code: 215200)
TEL: 86-512-6340-3008 / FAX: 86-512-6340-7290

Delta Greentech (China) Co., Ltd.

238 Min-Xia Road, Cao-Lu Industry Zone, Pudong, Shanghai,
People's Republic of China
Post code : 201209
TEL: 021-58635678 / FAX: 021-58630003

Delta Electronics (Japan), Inc.

Tokyo Office

Delta Shibadaimon Building, 2-1-14
Shibadaimon, Minato-Ku, Tokyo, 105-0012,
Japan
TEL: 81-3-5733-1111 / FAX: 81-3-5733-1211

Delta Electronics (Korea), Inc.

234-9, Duck Soo Building 7F, Nonhyun-Dong,
Kangnam-Gu, Seoul, Korea 135-010
TEL: 82-2-515-5305 / FAX: 82-2-515-5302

Delta Electronics (Singapore) Pte. Ltd.

8 Kaki Bukit Road 2, #04-18 Ruby Warehouse Complex,
Singapore 417841
TEL: 65-6747-5155 / FAX: 65-6744-9228

America

Delta Products Corporation (USA)

Raleigh Office

P.O. Box 12173, 5101 Davis Drive,
Research Triangle Park, NC 27709, U.S.A.
TEL: 1-919-767-3813 / FAX: 1-919-767-3969

Delta Products Corporation (Brazil)

Sao Paulo Office

Rua Itapeva, N° 26, 3° andar, Bela vista
ZIP: 01332-000 - São Paulo - SP - Brasil
TEL : 55-11-3568-3875 / FAX : 55-11-3568-3865

Europe

Deltronics (The Netherlands) B.V.

Eindhoven Office

De Witbogt 15, 5652 AG Eindhoven, The Netherlands
TEL: 31-40-2592850 / FAX: 31-40-2592851



ASDA-B2

Delta Electronics, Inc.
ASDA-B2

2-

ASDA-B2
ASDA-B2

0.1 3

ASDA-B2

ASDA-B2,

Delta IA

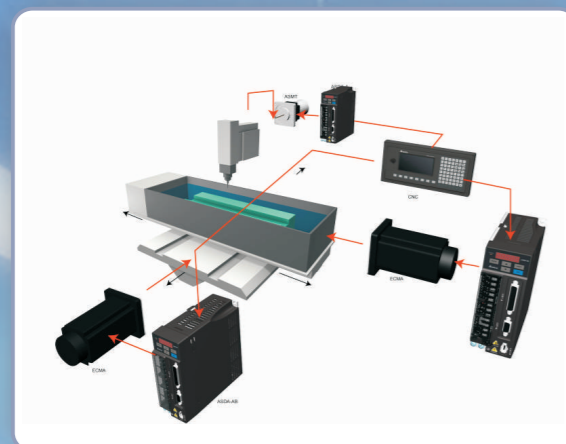
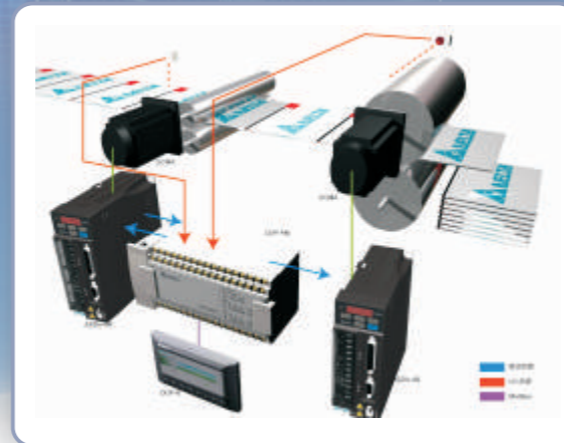
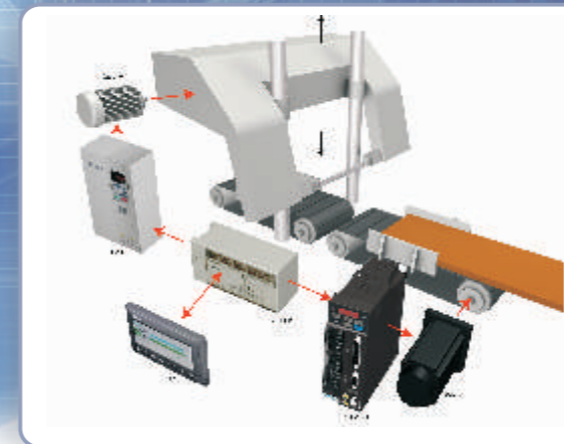
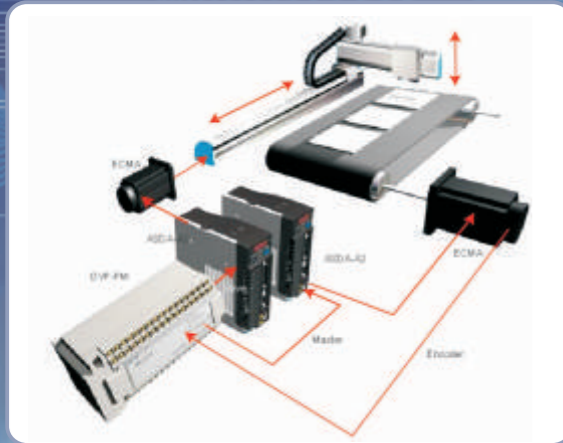

1. ASDA-B2 1

2. ASDA-B2 7

4. ECMA 17

5. 23

6. 29

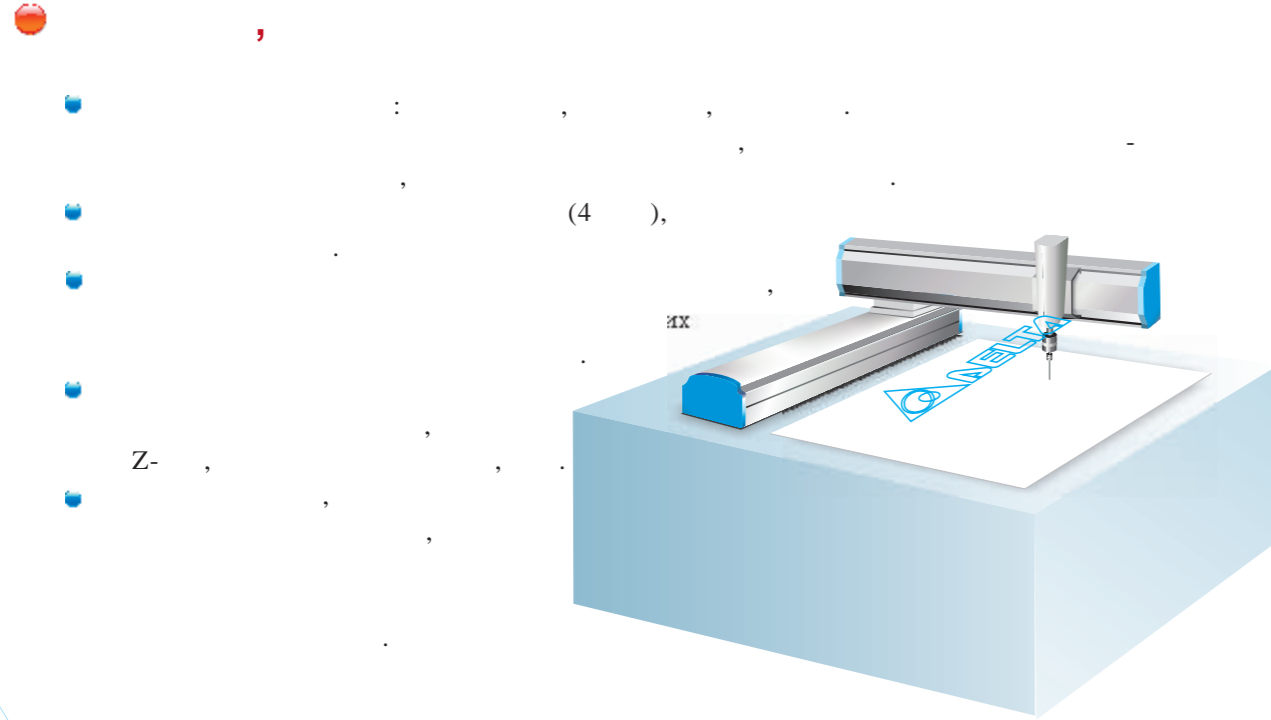
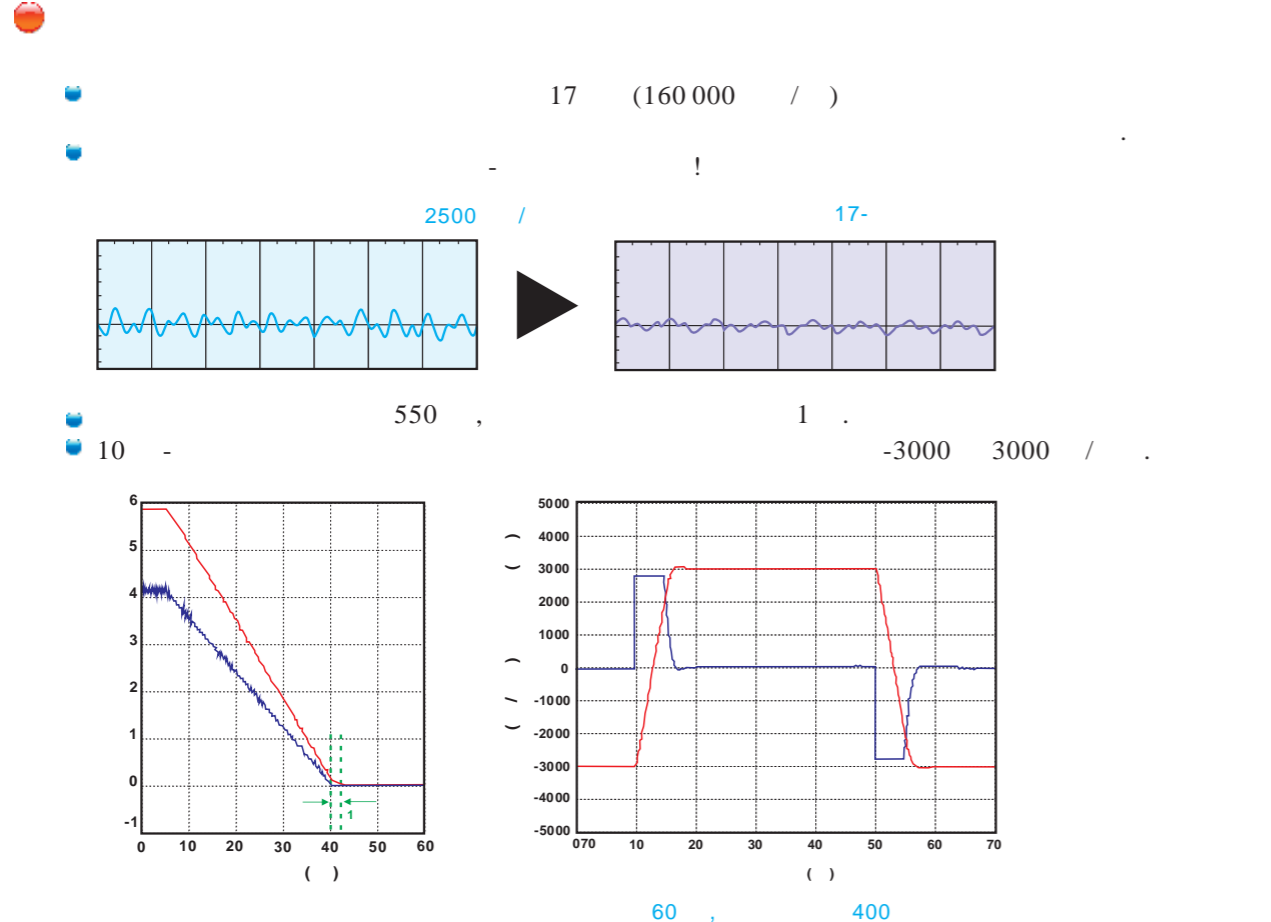

ASDA-B, ASDA-B2.

и упрощает обслуживание.

В моделях от 750Вт имеется встроенный тормозной резистор. Экономия места в шкафу и снижение затрат.

ASDA-Soft

ASD-CNUS0A08 ()

(. .24)

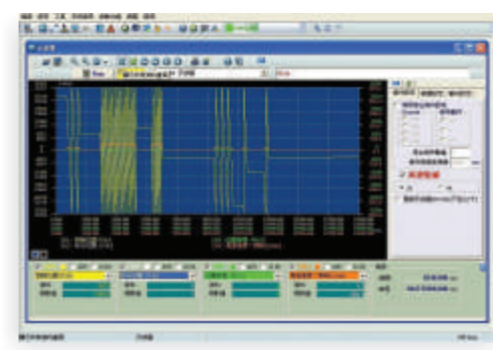

Code	Parameter Name	Value	Unit
000	Motor No.	0000	
001	Motor Type	0000	
002	Motor Power	0000	W
003	Motor Voltage	0000	V
004	Motor Current	0000	A
005	Motor Speed	0000	rpm
006	Motor Torque	0000	Nm
007	Motor Temperature	0000	°C
008	Motor Position	0000	mm
009	Motor Velocity	0000	mm/s
010	Motor Acceleration	0000	mm/s²
011	Motor Deceleration	0000	mm/s²
012	Motor Position Error	0000	mm
013	Motor Velocity Error	0000	mm/s
014	Motor Acceleration Error	0000	mm/s²
015	Motor Torque Error	0000	Nm
016	Motor Temperature Error	0000	°C
017	Motor Position Error	0000	mm
018	Motor Velocity Error	0000	mm/s
019	Motor Acceleration Error	0000	mm/s²
020	Motor Torque Error	0000	Nm
021	Motor Temperature Error	0000	°C

ASDA-B2

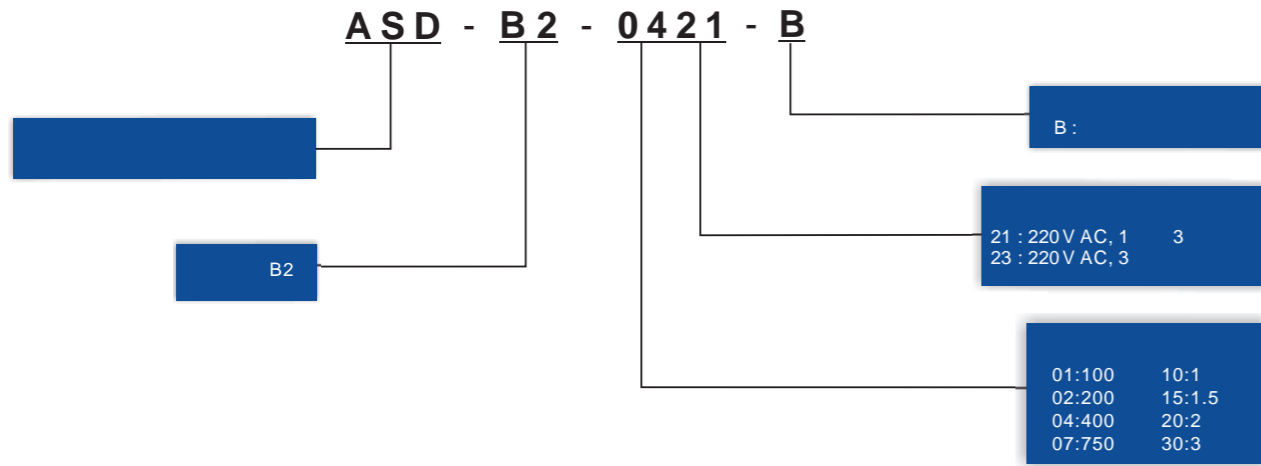

ECMA

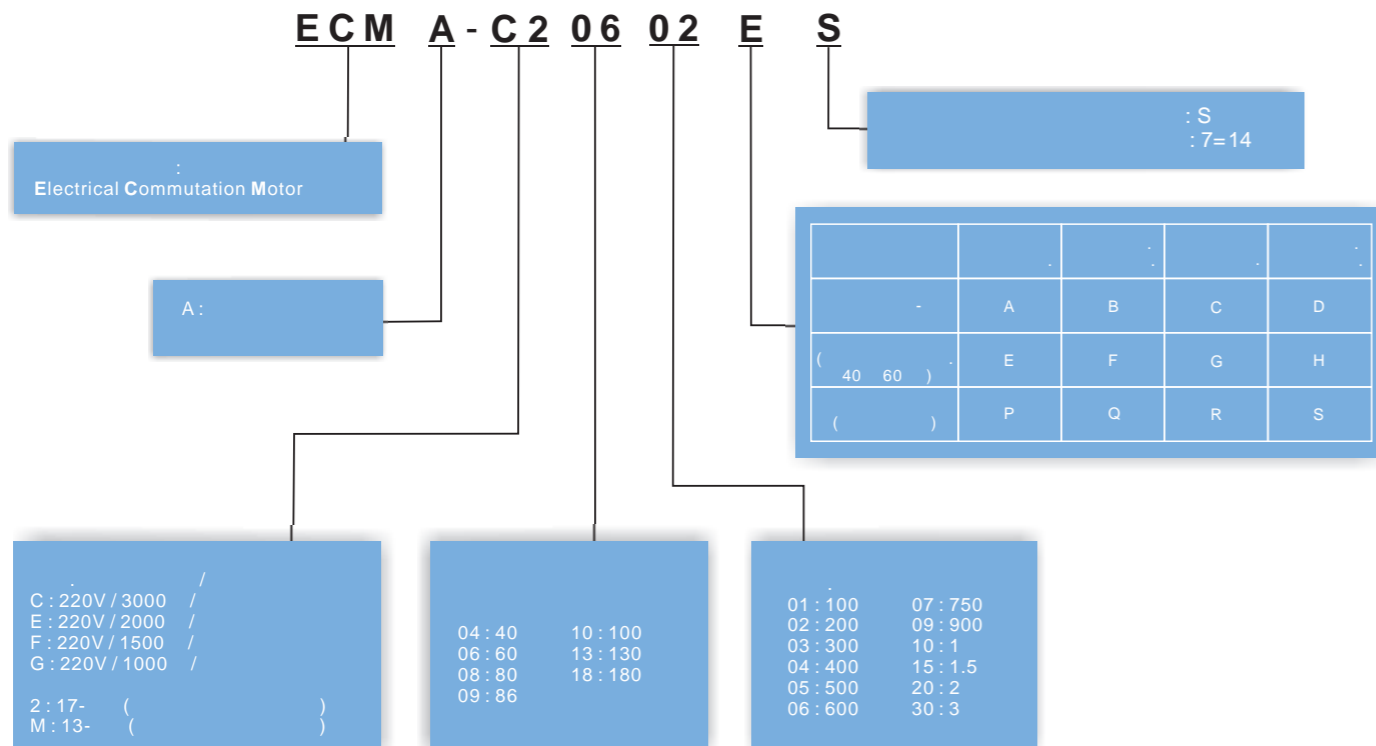

Servo Drive								
	0.1	0.2	0.4	0.75	1.0	1.5	2	3
	ASD-B2-0121-B	ASD-B2-0221-B	ASD-B2-0421-B	ASD-B2-0721-B	ASD-B2-1021-B	ASD-B2-1521-B	ASD-B2-2023-B	ASD-B2-3023-B

Servo Motor								
	ECMA-C20401□S	ECMA-C20602□S	ECMA-C20604□S ECMA-CM0604PS ECMA-C20804□7 ECMA-E21305□S ECMA-G21303□S	ECMA-C20807□S ECMA-G21306□S ECMA-GM1306PS ECMA-C20907□S	ECMA-C21010□S ECMA-E21310□S ECMA-G21309□S ECMA-GM1309PS ECMA-C20910□S	ECMA-E21315□S	ECMA-C21020□S ECMA-E21320□S ECMA-E21820□S	ECMA-E21830□S ECMA-F21830□S



LED-

■ 5- , 7-

●

■

●

■ 5
MODE -
SHIFT -

▲ -

▼ -

SET -

●

(L1c, L2c)

■ 100~230 , 50/60

●

(R, S, T)

■ 200~230 , 50/60

●

(U, V, W)

■

- 1. Когда используется внешний тормозной резистор, он подключается к клеммам P \oplus и C, а клеммы P \ominus и D должны быть открыты.
- 2. Когда используется внутренний тормозной клеммы P \oplus и D должны быть замкнуты, а клеммы P \ominus и C должны быть открыты.
- 3. Когда используется внешний тормозной модуль, он подключается к клеммам P \oplus и \ominus , а клеммы P \ominus и D, и P \oplus и C должны быть открыты.



●

■

●

■

●

■

PC, PLC, HMI, ...,
RS-485 / RS-232.

●

■

MON1 MON2.

●

■

(Pt)

(S)

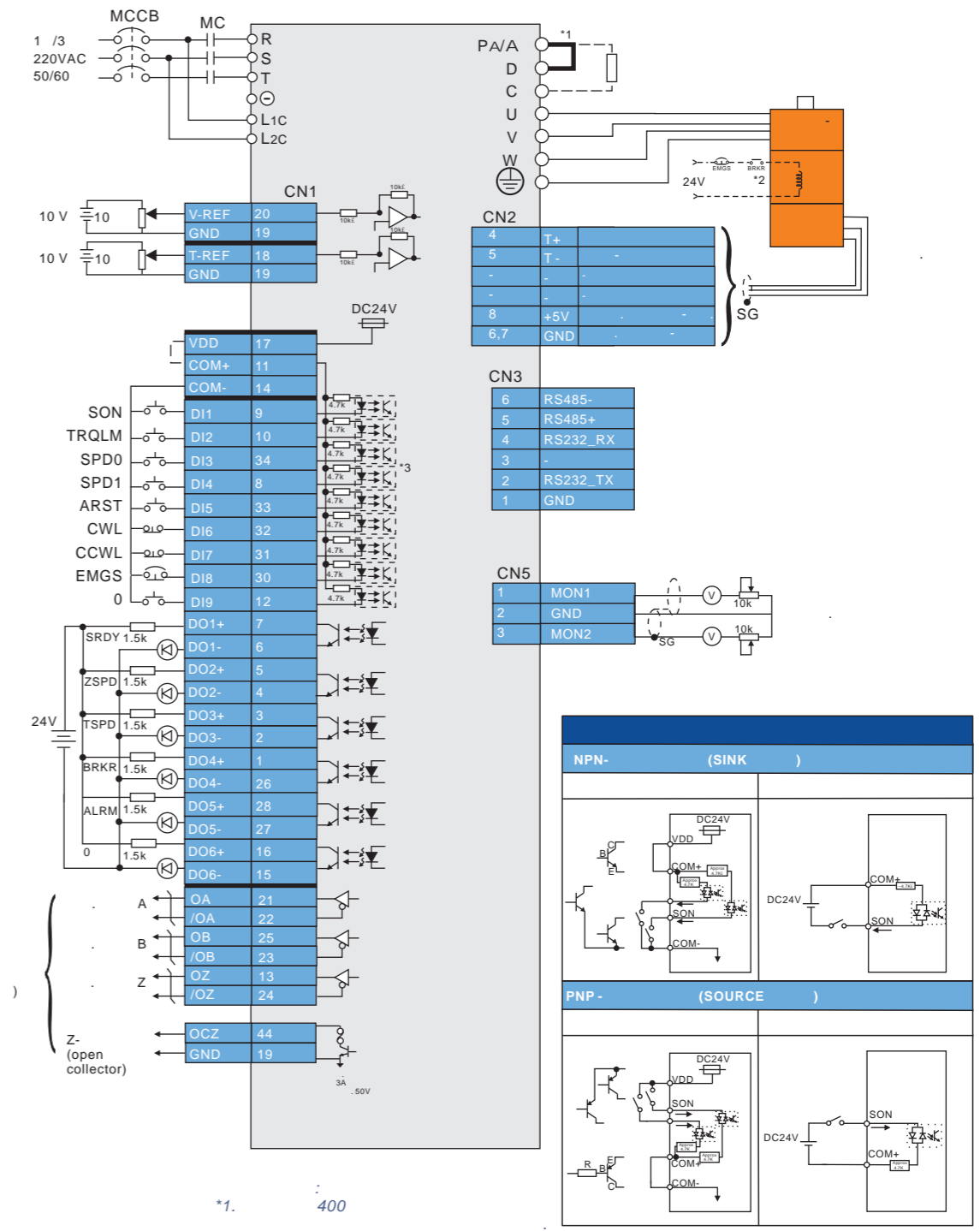
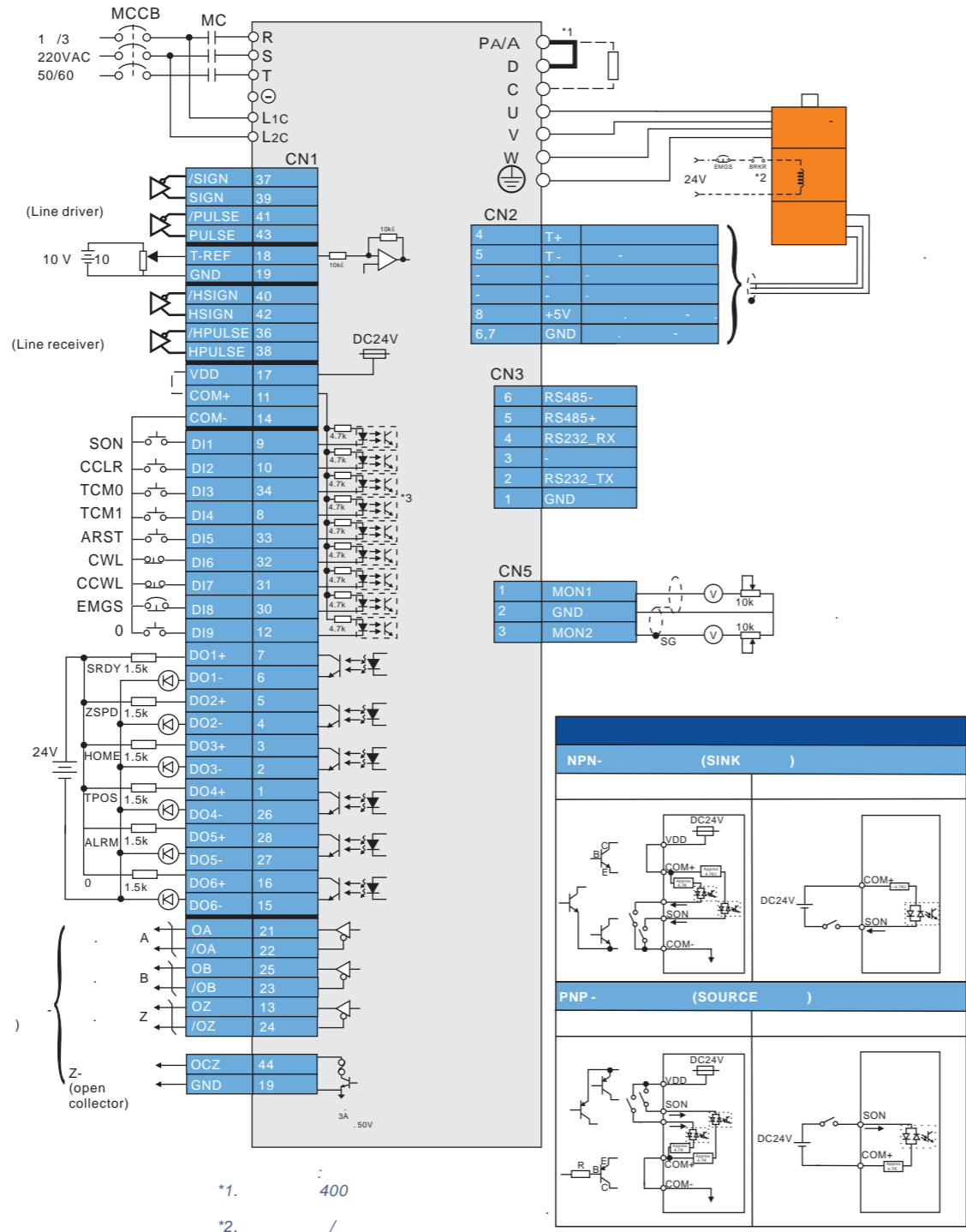
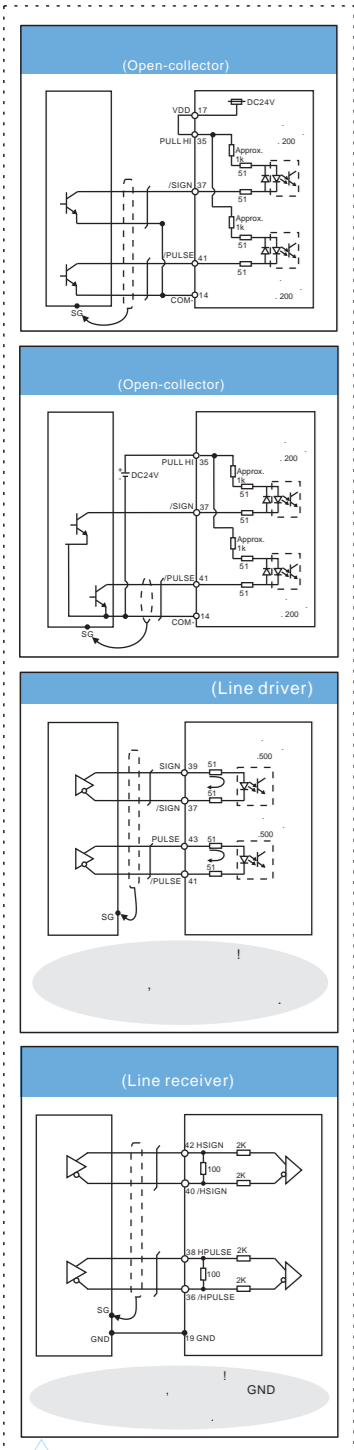

()

(T)

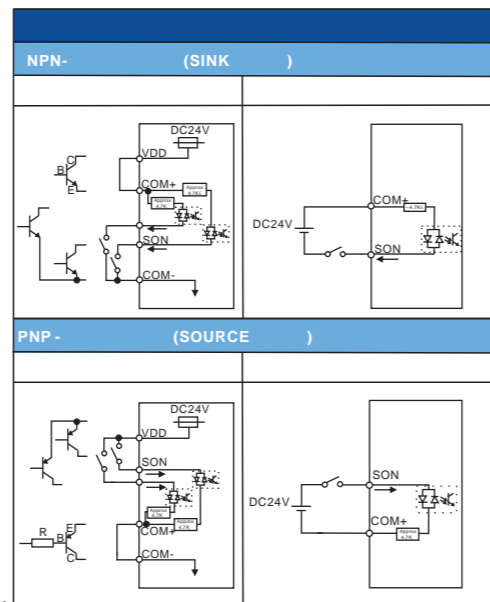
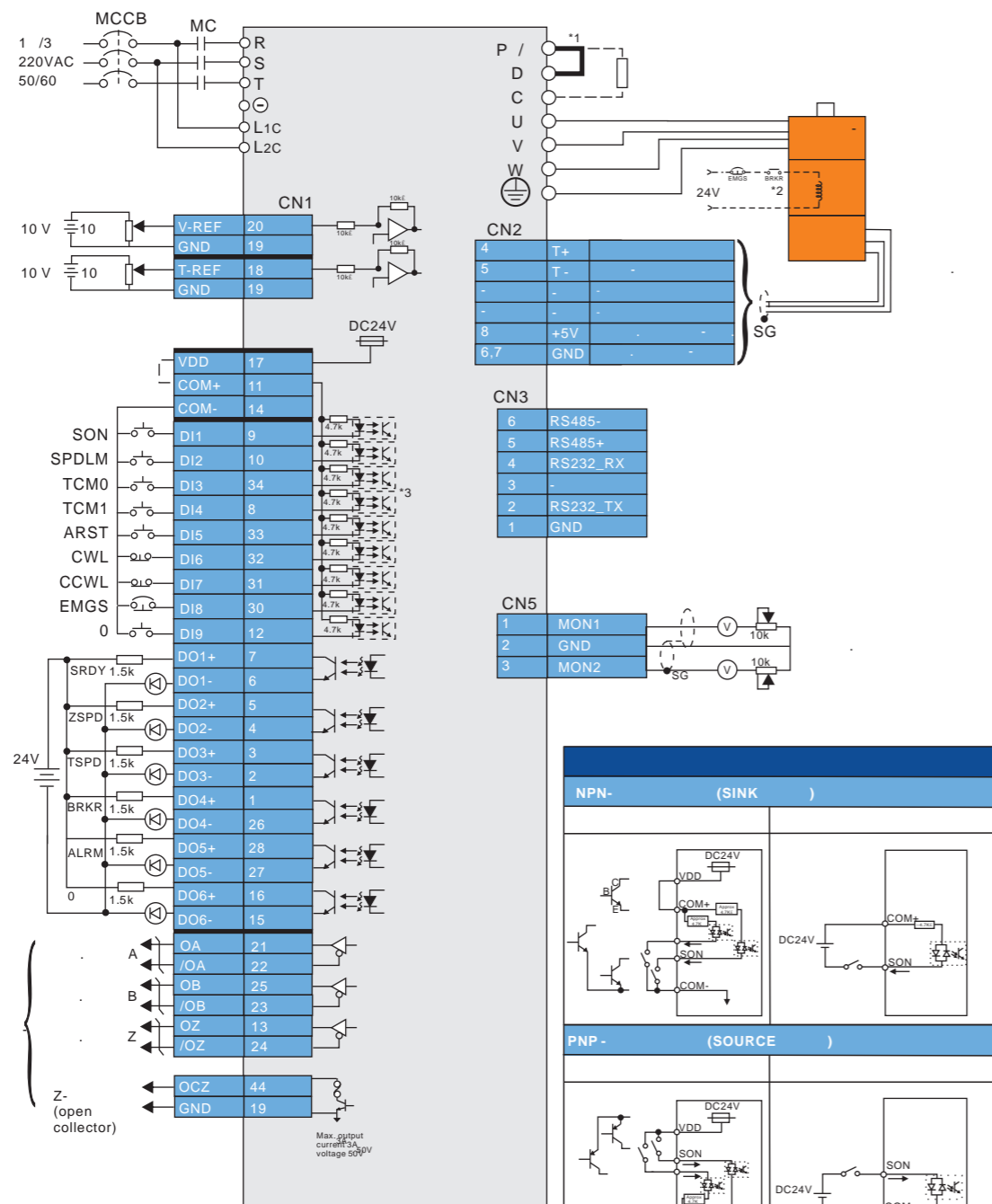

*1. 400
*2. /



()	()		-	()
	(P1-52)	(P1-53)		
0.1	--	--	80W	60W
0.2	--	--	80W	60W
0.4	--	--	80W	60W
0.75	100W	60	80W	60W
1.0	40W	60	40W	30W
1.5	40W	60	40W	30W
2.0	40W	60	30W	15W
3.0	40W	60	30W	15W

◆ ASDA-B2 400 ALE05 ()
◆ ()
◆

ASDA-B2 (IEC, EN,),	
	EN61000-4-6 Level 3
	EN61000-4-3 Level 3
	EN61000-4-2 Level 2 and 3
	EN61000-4-4 Level 3
	EN61000-4-8 Level 4
	EN61000-4-5 Level 3
	EN550011 Class A Group 1, 2006/95/EC
CE	2004/108/EC. IEC/EN50178, IEC/EN60529 IP20
	1G 20 , 0.6G 20...50 IEC/EN50178
	15G/11 IEC/EN600028-2-27
	2 IEC/EN61800-5-1
	: 0°C~55°C () : -20°C~65°C ()
	ASD-B2-0121-B, ASD-B2-0221-B, ASD-B2-0421-B, ASD-B2-0721-B - ASD-B2-1021-B, ASD-B2-1521-B, ASD-B2-2023-B, ASD-B2-3023-B -
	1000



ASDA-B2	100	200	400	750	1	1.5	2	3
	01	02	04	07	10	15	20	30
	3, 170 ~ 255VAC, 50/60 ± 5%				3, 170~255VAC, 50/60 ±5%			
	1, 200 ~ 255VAC, 50/60 + 5%							
	0.9 A	1.55 A	2.6 A	5.1 A	7.3 A	8.3 A	13.4 A	19.4 A
	17 (160 000 /)							
	SVPWM (-)							
	.500 (Line driver) / .200 (Open collector)				.4 (Line receiver) /			
	+ / A + B / CCW + CW							
	N/M - / N: 1 ~ (2 ²⁶ -1), M: 1 ~ (2 ³¹ -1) (1/50 < N/M < 25600)							
	0 ... ±10 V _{DC}							
	10							
	2.2							
	1:5000							
	/							
	S-							
	.500							
	0.01%				0 100% ()			
	0.01%				±10% ()			
	0.01%				0 50 °C			
	()							
	0 ... ±10 V _{DC}							
	10							
	2.2							
	/							

ASDA-B2 Series	100	200	400	750	1	1.5	2	3
	01	02	04	07	10	15	20	30
	(: ±8V)							
	«Servo On»,							
	(A, B, Z - , Z-)							
	Protective Functions							
	U, V, W, CN1, CN2, CN3							
	RS-232 / RS-485							
	()							
	1000							
	86 106							
	0 ~ 55 °C (45 °C)							
	-20 65 °C							
	0 90% ()							
	9.80665 / ² (1G) 20 , 5.88 / ² (0.6G) 20 ? 50Hz							
	IP20							
	TN ¹³							
	IEC/EN 61800-5-1							

*1 :
 *2 :
 *3 TN-





100 / 200 / 400

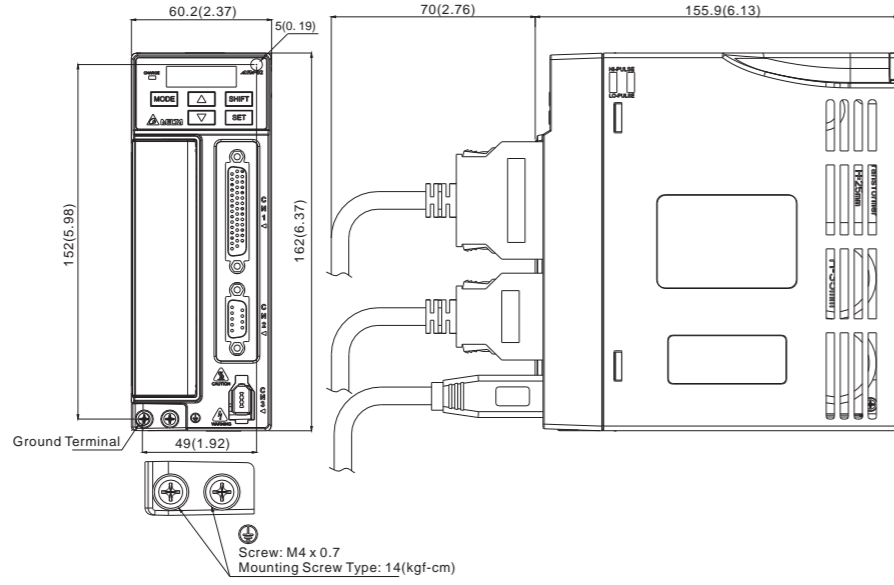

1 / 1.5

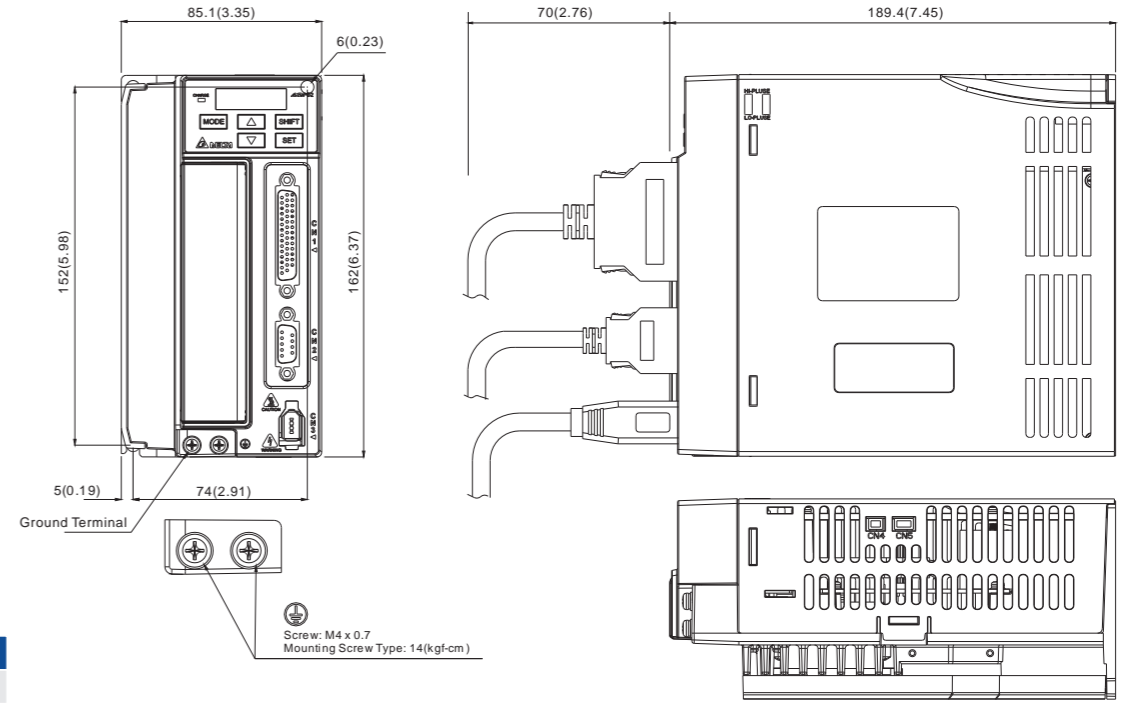

750

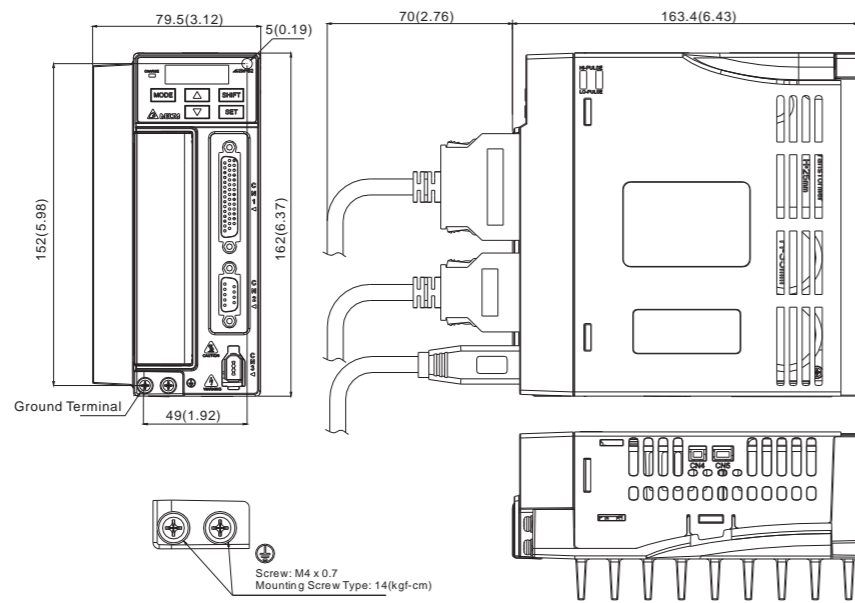

2 / 3

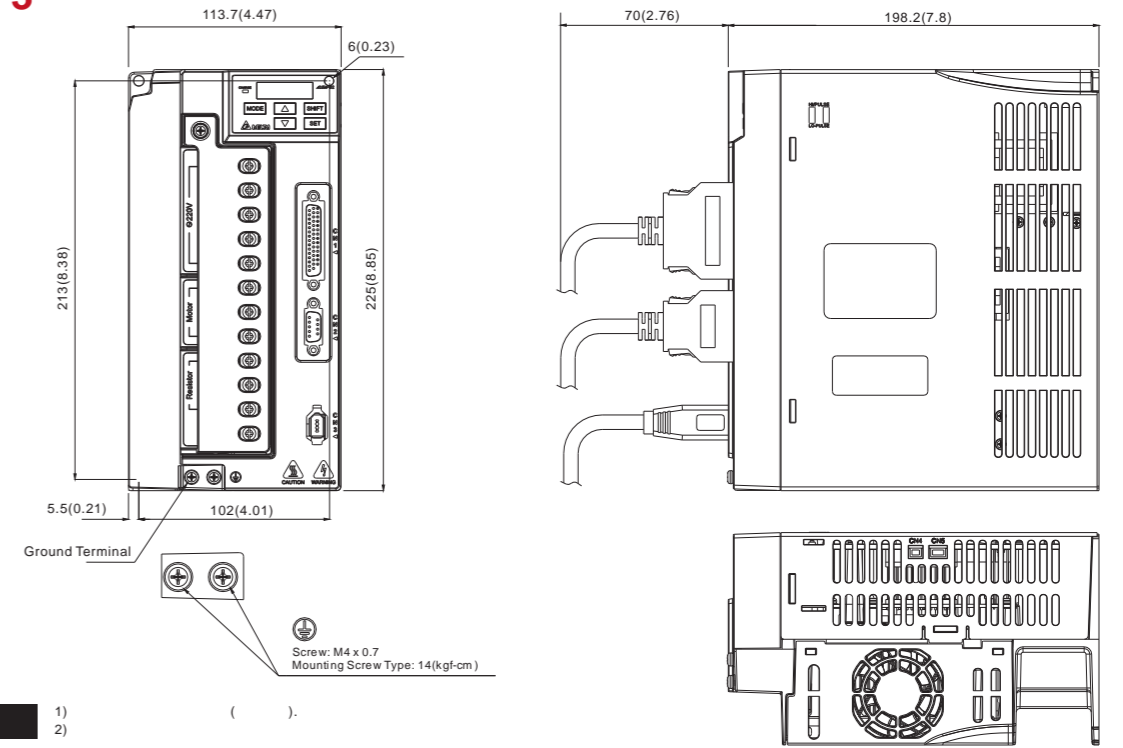

ECMA	C204		C206		C208		C209		C210	
	01	02	04	04	07	07	10	10	20	
()	0.1	0.2	0.4	0.4	0.75	0.75	1.0	1.0	2.0	
(·) ¹¹	0.32	0.64	1.27	1.27	2.39	2.39	3.18	3.18	6.37	
(·)	0.96	1.92	3.82	3.82	7.16	7.14	8.78	9.54	19.1	
(·)	3000			3000			3000			
(/)	5000			3000			5000			
(A)	0.90	1.55	2.60	2.60	5.10	3.66	4.25	7.30	12.05	
(A)	2.70	4.65	7.80	7.24	15.3	11	12.37	21.9	36.15	
(kW/s)	27.7	22.4	57.6	22.1	48.4	29.6	38.6	38.1	90.6	
(10 ⁻⁴ *)	0.037	0.177	0.277	0.68	1.13	1.93	2.62	2.65	4.45	
()	0.75	0.80	0.53	0.73	0.62	1.72	1.20	0.74	0.61	
-KT (N-m/A)	0.36	0.41	0.49	0.49	0.47	0.65	0.75	0.44	0.53	
-KE (mV/(r/min))	13.6	16.0	17.4	18.5	17.2	27.5	24.2	16.8	19.2	
()	9.30	2.79	1.55	0.93	0.42	1.34	0.897	0.20	0.13	
()	24.0	12.07	6.71	7.39	3.53	7.55	5.7	1.81	1.50	
()	2.58	4.30	4.30	7.96	8.36	5.66	6.35	9.30	11.4	
	(UL), (CE)									
	>100MVDC 500V									
	1500V AC, 60									
()	0.5	1.2	1.6	2.1	3.0	2.9	3.8	4.3	6.2	
()	0.8	1.5	2.0	2.9	3.8	3.69	5.5	4.7	7.2	
()	78.4	196	196	245	245	245	245	490	490	
(N)	39.2	68	68	98	98	98	98	98	98	
(kW/s)	25.6	21.3	53.8	22.1	48.4	29.3	37.9	30.4	82.0	
(10 ⁻⁴ *)	0.04	0.19	0.30	0.73	1.18	1.95	2.67	3.33	4.95	
() ()	0.81	0.85	0.57	0.78	0.65	1.74	1.22	0.93	0.66	
(* ())	0.3	1.3	1.3	2.5	2.5	2.5	2.5	8.0	8.0	
(20°C) []	7.2	6.5	6.5	8.2	8.2	8.2	8.2	18.5	18.5	
(,)	5	10	10	10	10	10	10	10	10	
(,)	25	70	70	70	70	70	70	70	70	
()	15									
(°C)	0 ~ 40									
(°C)	-10 ~ 80									
	20 ~ 90%RH ()									
	20 ~ 90%RH ()									
	2.5G									
	IP65 ()									

ECMA	E213				E218		F218	G213		
	05	10	15	20	20	30	30	03	06	09
()	0.5	1.0	1.5	2.0	2.0	3.0	3.0	0.3	0.6	0.9
(·) ¹¹	2.39	4.77	7.16	9.55	9.55	14.32	19.10	2.86	5.73	8.59
(·)	7.16	14.32	21.48	28.65	28.65	42.97	57.29	8.59	17.19	21.48
(·)	2000						1500	1000		
(/)	3000						2000			
(A)	2.9	5.6	8.3	11.01	11.22	16.1	19.4	2.5	4.8	7.5
(A)	8.7	16.8	24.81	33.03	33.66	48.3	58.2	7.44	14.49	22.5
(kW/s)	7.0	27.1	45.9	62.5	26.3	37.3	66.4	10.0	39.0	66.0
(10 ⁻⁴ *)	8.17	8.41	11.18	14.59	34.68	54.95	54.95	8.17	8.41	11.18
()	1.91	1.51	1.11	0.96	1.62	1.06	1.28	1.84	1.40	1.07
-KT (N-m/A)	0.83	0.85	0.87	0.87	0.85	0.89	0.98	1.15	1.19	1.15
-KE (mV/(r/min))	30.9	31.9	31.8	31.8	31.4	32.0	35.0	42.5	43.8	41.6
()	0.57	0.47	0.26	0.174	0.119	0.052	0.077	1.06	0.82	0.43
()	7.39	5.99	4.01	2.76	2.84	1.38	1.27	14.29	11.12	6.97
()	12.96	12.88	15.31	15.86	23.87	26.39	16.51	13.55	13.55	16.06
	(UL), (CE)									
	>100MVDC 500V									
	1500V AC, 60									
()	6.8	7.0	7.5	7.8	13.5	18.5	18.5	6.8	7.0	7.5
()	8.2	8.4	8.9	9.2	17.5	22.5	22.5	8.2	8.4	8.9
()	490	490	490	490	1176	1470	1470	490	490	490
(N)	98	98	98	98	490	490	490	98	98	98
(kW/s)	6.4	24.9	43.1	59.7	24.1	35.9	63.9	9.2	35.9	62.1
(10 ⁻⁴ *)	8.94	9.14	11.90	15.88	37.86	57.06	57.06	8.94	9.14	11.9
() ()	2.07	1.64	1.19	1.05	1.77	1.10	1.33	2.0	1.51	1.13
(* ())	16.5	16.5	16.5	16.5	25.0	25.0	25.0	10.0	10.0	10.0
(20°C) []	21.0	21.0	21.0	21.0	20.4	20.4	20.4	19.0	19.0	19.0
(,)	5.0	5.0	5.0	5.0	5.0	5.0	5.0	5.0	5.0	5.0
(,)	25.0	25.0	25.0	25.0	25.0	25.0	25.0	25.0	25.0	25.0
()	15									
(°C)	0 ~ 40									
(°C)	-10 ~ 80									
	20 ~ 90%RH ()									
	20 ~ 90%RH ()									
	2.5G									
	IP65 ()									

80

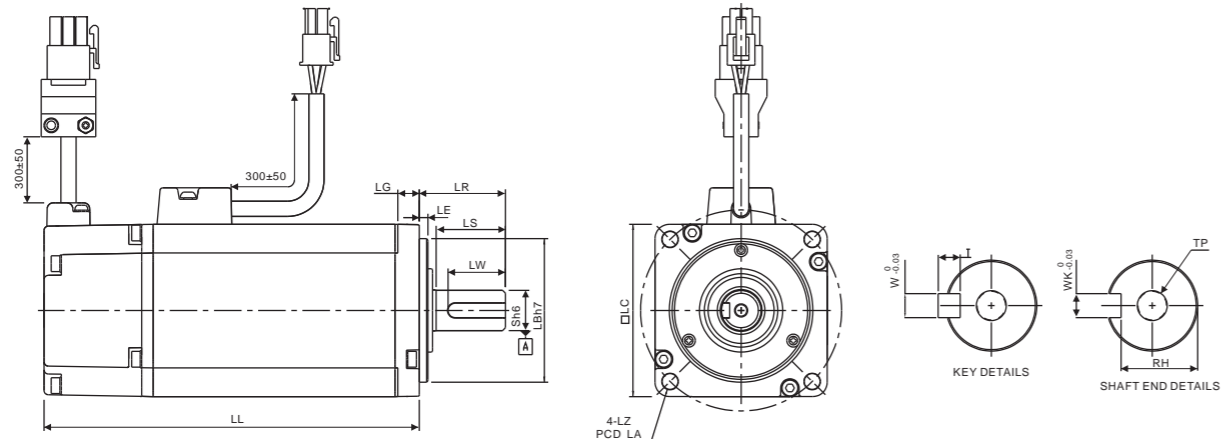

	C20401 □ S	C20602 □ S	C20604 □ S	C20804 □ S	C20807 S	C20907 □ S	C20910 □ S
LC	40	60	60	80	80	86	86
LZ	4.5	5.5	5.5	6.6	6.6	6.6	6.6
LA	46	70	70	90	90	100	100
S	8 ^(+0/-0.009)	14 ^(+0/-0.011)	14 ^(+0/-0.011)	14 ^(+0/-0.011)	19 ^(+0/-0.013)	16 ^(+0/-0.011)	16 ^(+0/-0.011)
LB	30 ^(+0/-0.021)	50 ^(+0/-0.025)	50 ^(+0/-0.025)	70 ^(+0/-0.030)	70 ^(+0/-0.030)	80 ^(+0/-0.030)	80 ^(+0/-0.030)
LL()	100.6	105.5	130.7	112.3	138.3	130.2	153.2
LL()	136.6	141.6	166.8	152.8	178	161.3	184.3
LS()	20	27	27	27	32	30	30
LS()	20	24	24	24.5	29.5	30	30
LR	25	30	30	30	35	35	35
LE	2.5	3	3	3	3	3	3
LG	5	7.5	7.5	8	8	8	8
LW	16	20	20	20	25	20	20
RH	6.2	11	11	11	15.5	13	13
WK	3	5	5	5	6	5	5
W	3	5	5	5	6	5	5
T	3	5	5	5	6	5	5
TP	M3 .8	M4 .15	M4 .15	M4 .15	M6 .20	M5 .15	M5 .15



100 ~ 130

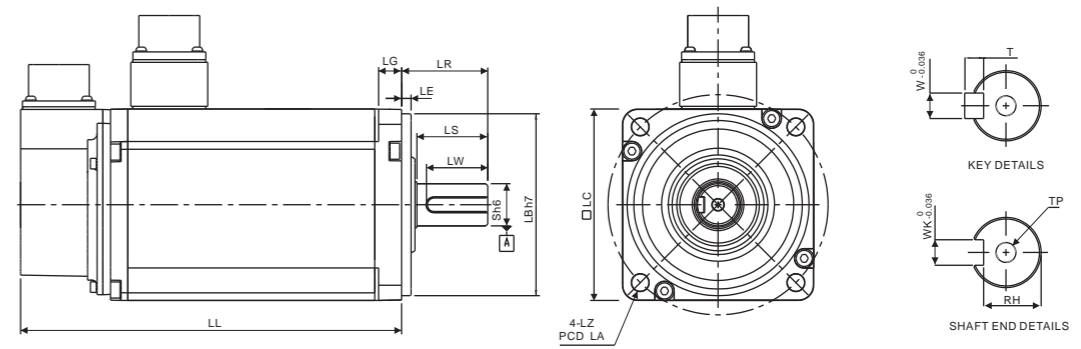

	G21303 □ S	E21305 □ S	G21306 □ S	G21309 □ S	C21010 □ S
LC	130	130	130	130	100
LZ	9	9	9	9	9
LA	145	145	145	145	115
S	22 ^(+0/-0.013)	22 ^(+0/-0.013)	22 ^(+0/-0.013)	22 ^(+0/-0.013)	22 ^(+0/-0.013)
LB	110 ^(+0/-0.035)	110 ^(+0/-0.035)	110 ^(+0/-0.035)	110 ^(+0/-0.035)	95 ^(+0/-0.035)
LL()	147.5	147.5	147.5	163.5	153.3
LL()	183.5	183.5	183.5	198	192.5
LS	47	47	47	47	37
LR	55	55	55	55	45
LE	6	6	6	6	5
LG	11.5	11.5	11.5	11.5	12
LW	36	36	36	36	32
RH	18	18	18	18	18
WK	8	8	8	8	8
W	8	8	8	8	8
T	7	7	7	7	7
TP	M6 .20	M6 .20	M6 .20	M6 .20	M6 .20

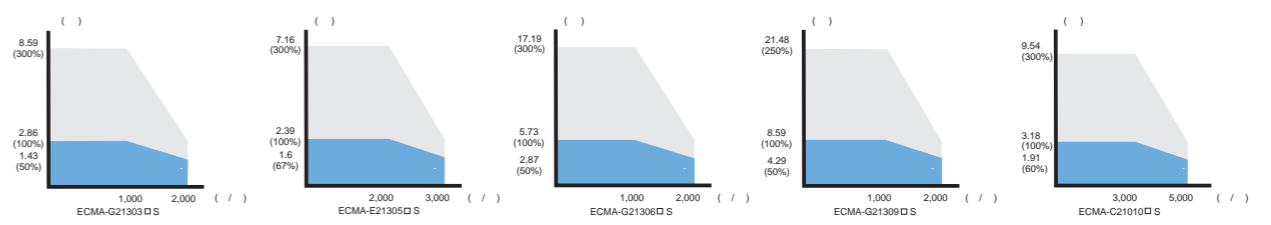
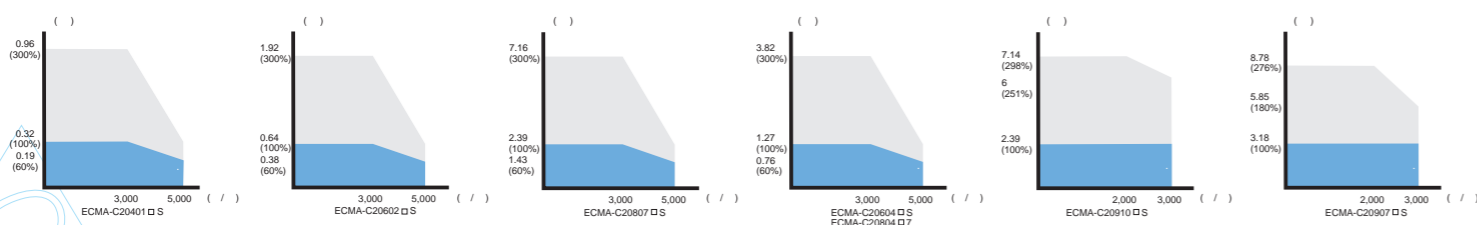
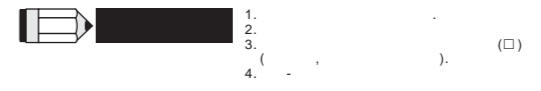

100 ~ 130

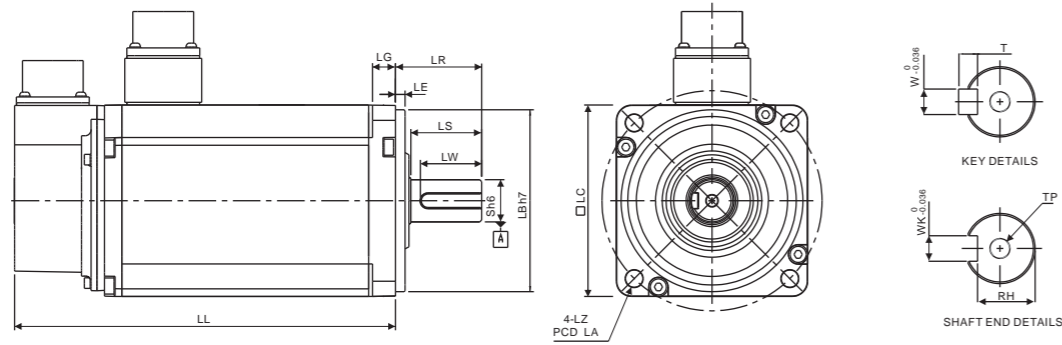

	E21310□S	E21315□S	C21020□S	E21320□S
LC	130	130	100	130
LZ	9	9	9	9
LA	145	145	115	145
S	22 ^(+0/-0.013)	22 ^(+0/-0.013)	22 ^(+0/-0.013)	22 ^(+0/-0.013)
LB	110 ^(+0/-0.035)	110 ^(+0/-0.035)	95 ^(+0/-0.035)	110 ^(+0/-0.035)
LL()	147.5	167.5	199	187.5
LL()	183.5	202	226	216
LS	47	47	37	47
LR	55	55	45	55
LE	6	6	5	6
LG	11.5	11.5	12	11.5
LW	36	36	32	36
RH	18	18	18	18
WK	8	8	8	8
W	8	8	8	8
T	7	7	7	7
TP	M6 .20	M6 .20	M6 .20	M6 .20



180

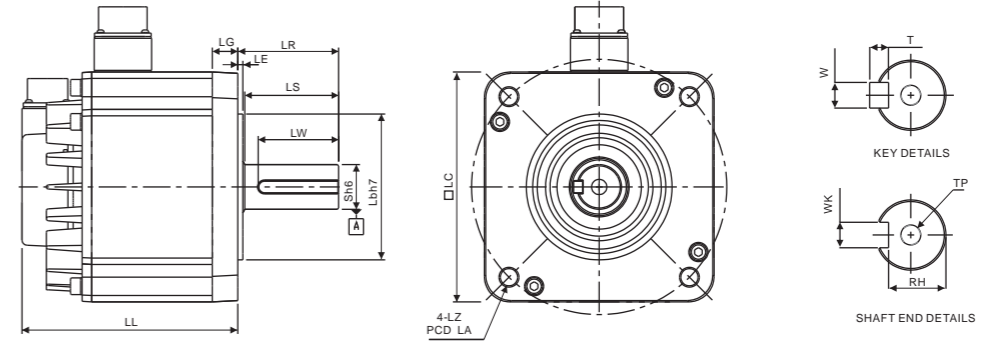

Model	E21820□S	E21830□S	F21830□S
LC	180	180	180
LZ	13.5	13.5	13.5
LA	200	200	200
S	35 ^(+0/-0.016)	35 ^(+0/-0.016)	35 ^(+0/-0.016)
LB	114.3 ^(+0/-0.035)	114.3 ^(+0/-0.035)	114.3 ^(+0/-0.035)
LL()	169	202.1	202.1
LL()	203.1	235.3	235.3
LS	73	73	73
LR	79	79	79
LE	4	4	4
LG	20	20	20
LW	63	63	63
RH	30	30	30
WK	10 ^{0/-0.036}	10 ^{0/-0.036}	10 ^{0/-0.036}
W	10 ^{0/-0.036}	10 ^{0/-0.036}	10 ^{0/-0.036}
T	8	8	8
TP	M12 .25	M12 .25	M12 .25

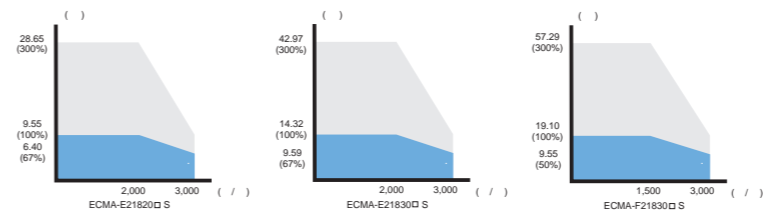
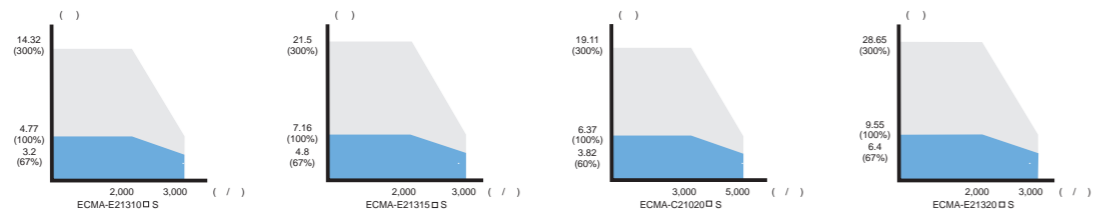
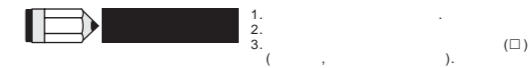

ASDA-B2



CN1



CN2

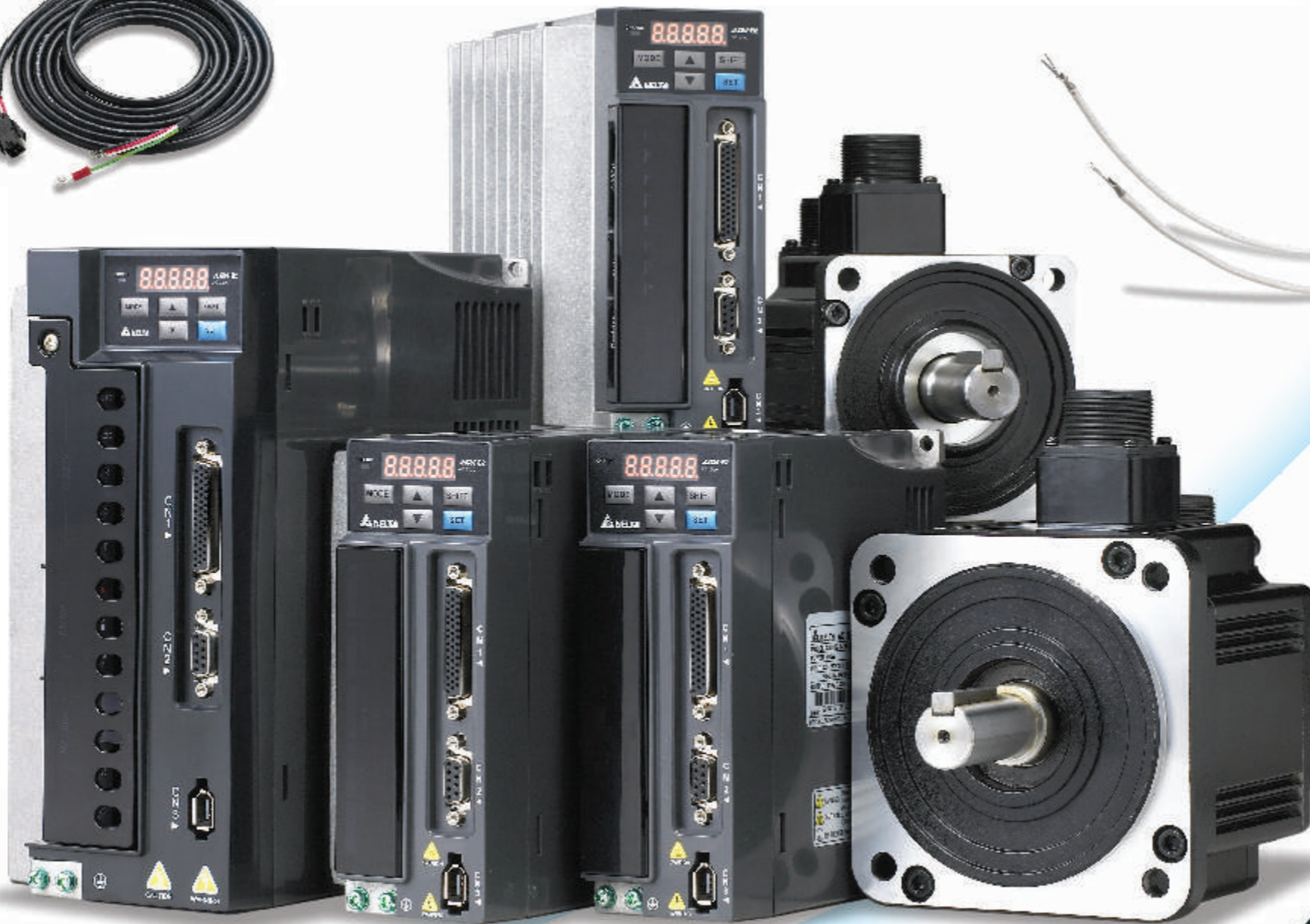

- 3- 5-
-

αβγδ/εζηθλα

- 3- 5-

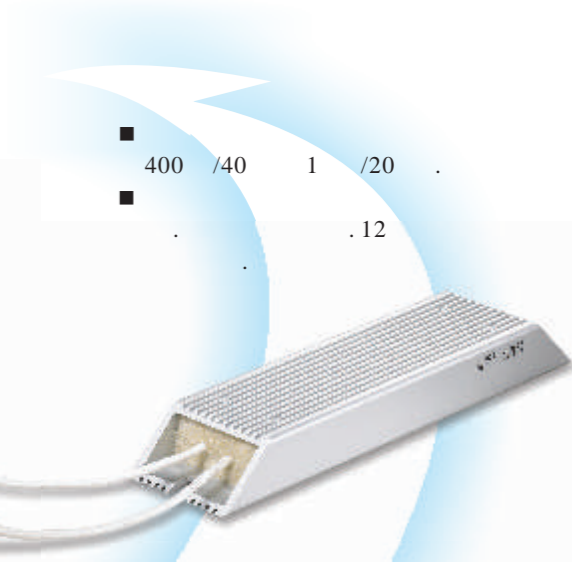

RS-485

- 400 /40 1 /20
- .12



ASD-Soft

RS-485 2 RJ45.



ASDA-B2

ASDBCAPW0000

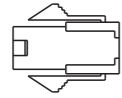

C4201H00-2*2PA	JOWLE
C4201TOP-2	JOWLE

ASDBCAPW0100

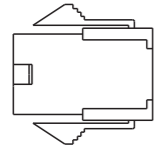

C4201H00-2*3PA	JOWLE
C4201TOP-2	JOWLE

ASD-CAPW1000

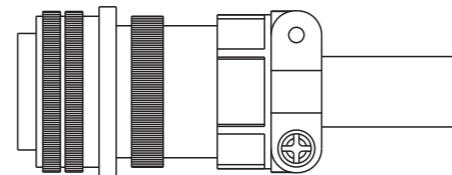

MS 3106A-20-18S

ASD-CAPW2000

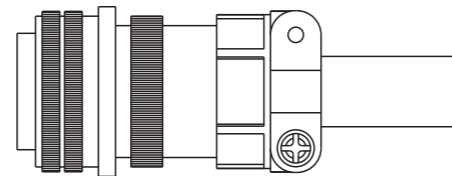

MS 3106A-24-11S

ASDBCAPW0203/0205

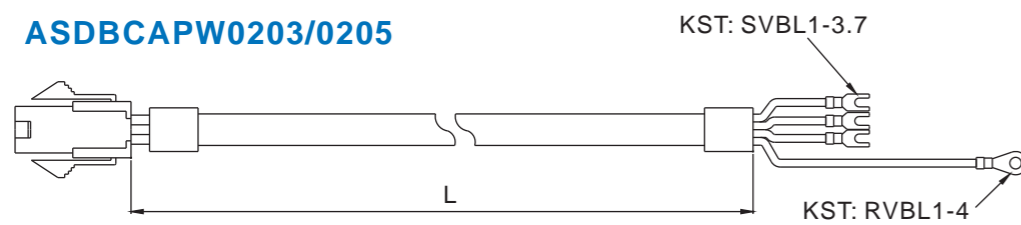

C4201H00-2*2PA	JOWLE
C4201TOP-2	JOWLE

N		L
1	ASDBCAPW0203	3000 ± 50 118 ± 2
2	ASDBCAPW0205	5000 ± 50 197 ± 2

ASDBCAPW0303/0305

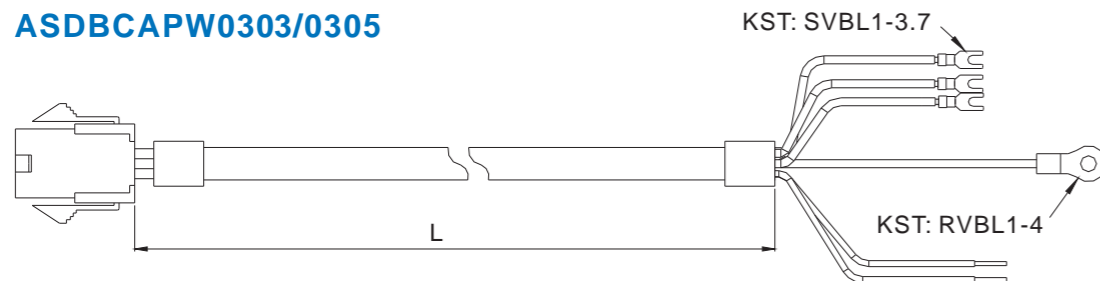

C4201H00-2*3PA	JOWLE
C4201TOP-2	JOWLE

N		L
1	ASDBCAPW0303	3000 ± 50 118 ± 2
2	ASDBCAPW0305	5000 ± 50 197 ± 2

ASD-CAPW1203/1205

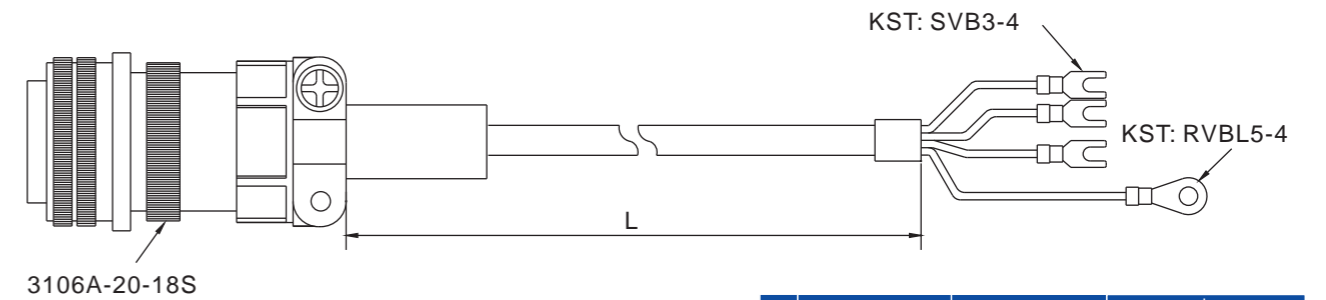

N		L
1	ASD-CAPW1203	3106A-20-18S 3000 ± 50 118 ± 2
2	ASD-CAPW1205	3106A-20-18S 5000 ± 50 197 ± 2

ASD-CAPW1303/1305

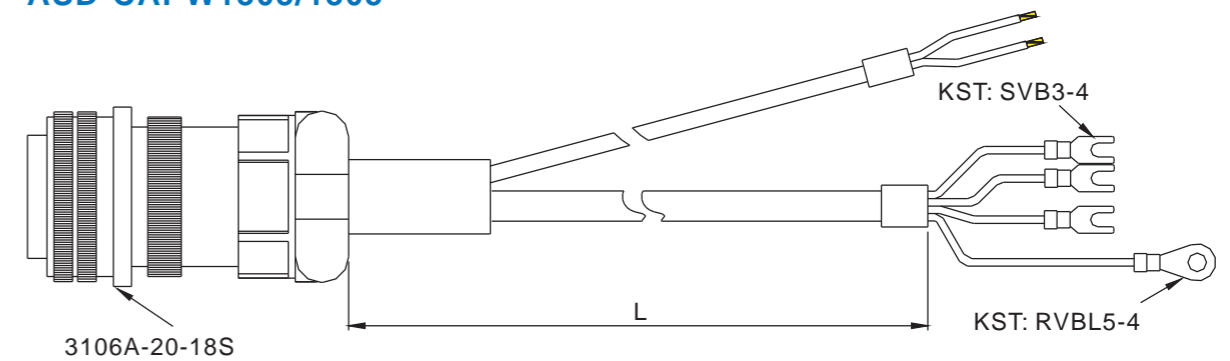

N		L
1	ASD-CAPW1303	3106A-20-18S 3000 ± 50 118 ± 2
2	ASD-CAPW1305	3106A-20-18S 5000 ± 50 197 ± 2

ASD-CAPW2203/2205

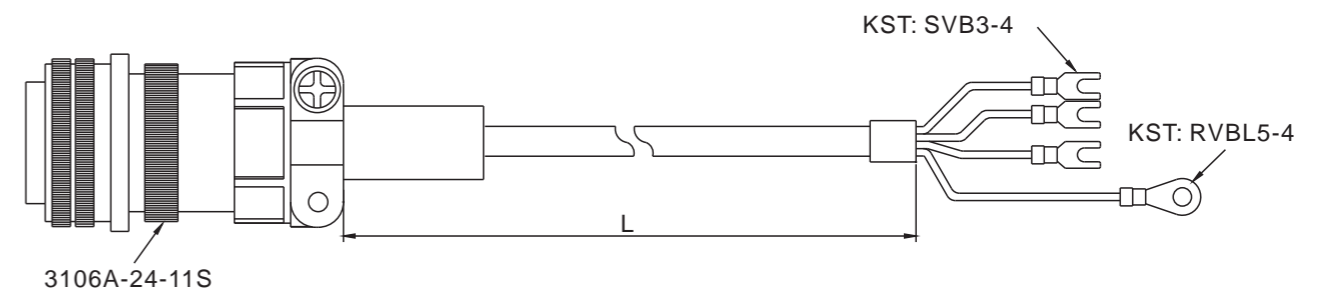

N		L
1	ASD-CAPW2203	3106A-24-11S 3000 ± 50 118 ± 2
2	ASD-CAPW2205	3106A-24-11S 5000 ± 50 197 ± 2

ASDA-B2

ASD-CAPW2303/2305

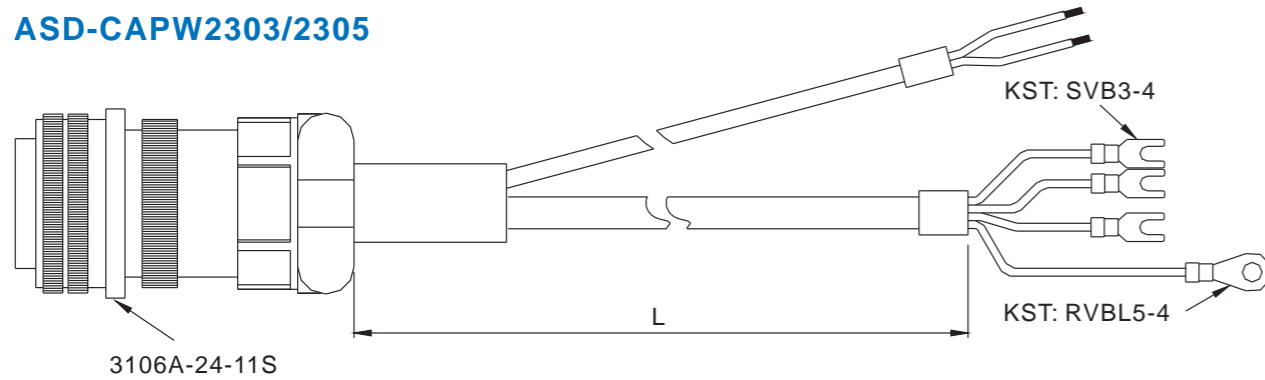

N			L	
1	ASD-CAPW2303	3106A-24-11S	3000 ± 50	118 ± 2
2	ASD-CAPW2305	3106A-24-11S	5000 ± 50	197 ± 2

ASDBCAEN0003/0005

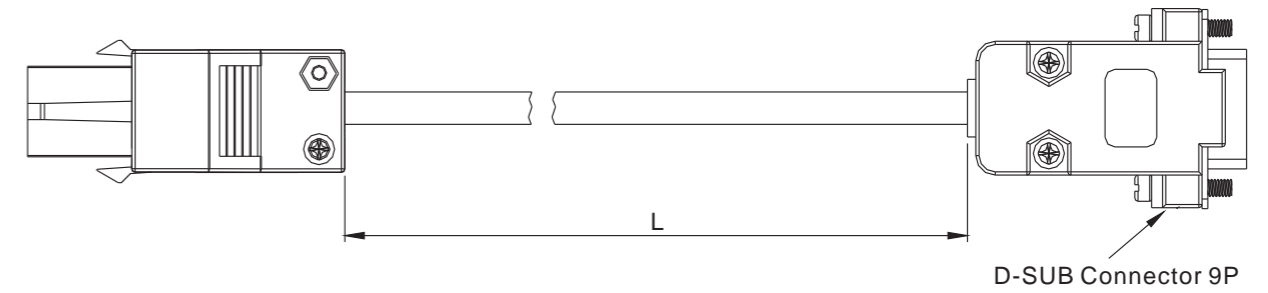

N		L		
1	ASDBCAEN0003	3000 ± 50	118 ± 2	AMP(1-172161-9) AMP
2	ASDBCAEN0005	5000 ± 50	197 ± 2	AMP(170359-3) AMP DELTA(34703237XX) DELTA

ASDBCAEN0000

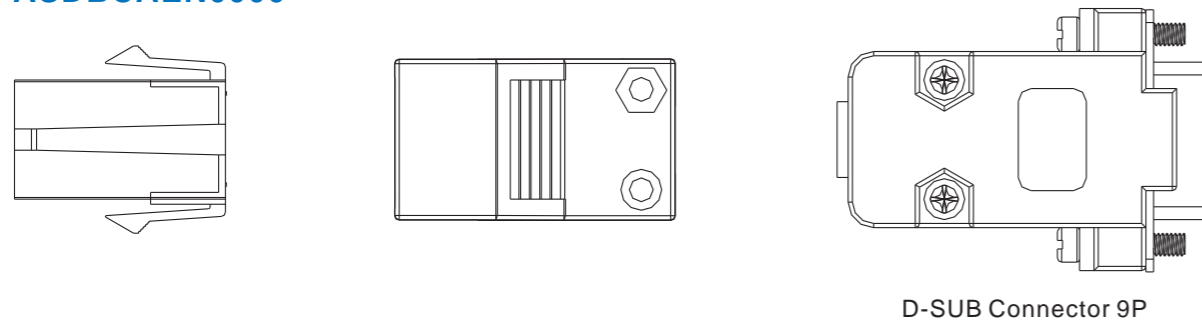

	AMP(1-172161-9)	AMP
	AMP(170359-3)	AMP
	DELTA(34703237XX)	DELTA

ASDBCAEN1000

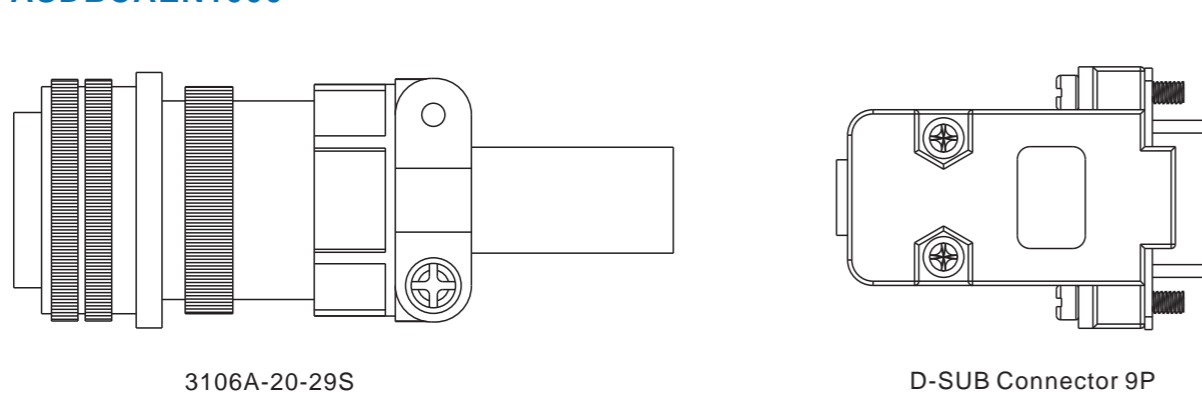

ASDBCAEN1003/1005

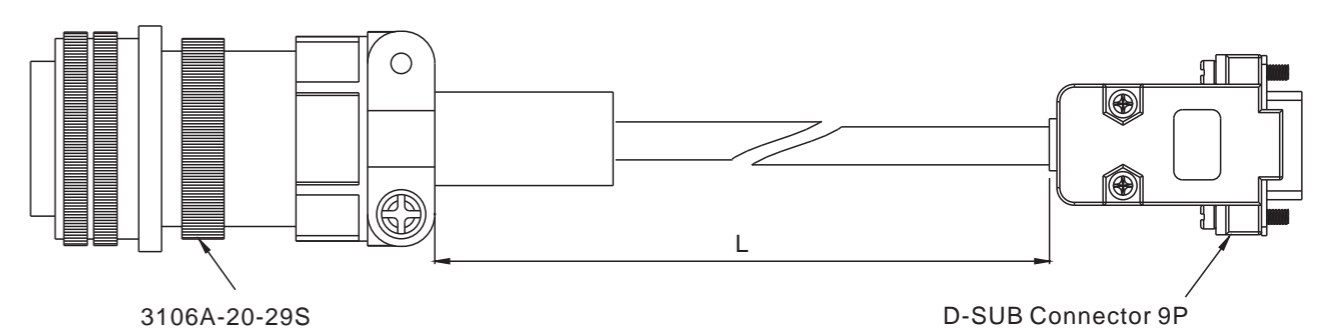

CN1

ASDBCNDS0044

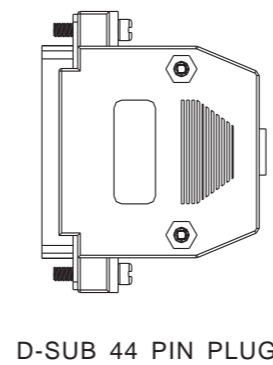

RS-485

ASD-CNIEOB06

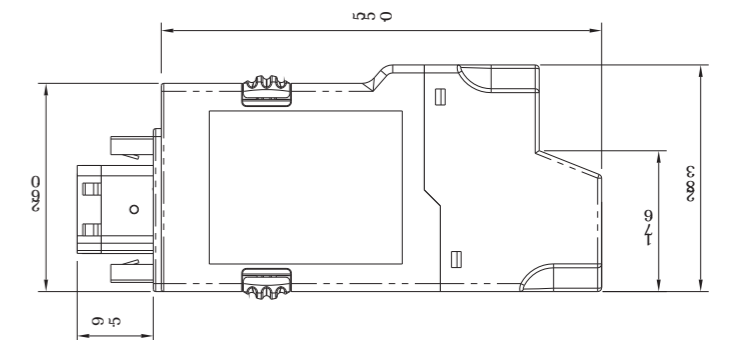



100

100

ASD-B2-0121-B			
ECMA-C20401□S			
3	5	3	5
ASDBCAPW0203	ASDBCAPW0205	ASDBCAPW0303	ASDBCAPW0305
ASDBCAEN0003	ASDBCAEN0005	ASDBCAEN0003	ASDBCAEN0005
ASDBCAPW0000		ASDBCAEN0000	

400

500

ASD-B2-0421-B			
ECMA-E21305□S			
3	5	3	5
ASDBCAPW1203	ASDBCAPW1205	ASDBCAPW1303	ASDBCAPW1305
ASDBCAEN1003	ASDBCAEN1005	ASDBCAEN1003	ASDBCAEN1005
ASDBCAPW1000		ASDBCAEN1000	

200

200

ASD-B2-0221-B			
ECMA-C20602□S			
3	5	3	5
ASDBCAPW0203	ASDBCAPW0205	ASDBCAPW0303	ASDBCAPW0305
ASDBCAEN0003	ASDBCAEN0005	ASDBCAEN0003	ASDBCAEN0005
ASDBCAPW0000		ASDBCAPW0100	
ASDBCAEN0000			

400

300

ASD-B2-0421-B			
ECMA-G21303□S			
3	5	3	5
ASD-CAPW1203	ASD-CAPW1205	ASD-CAPW1303	ASD-CAPW1305
ASDBCAEN1003	ASDBCAEN1005	ASDBCAEN1003	ASDBCAEN1005
ASD-CAPW1000		ASDBCAEN1000	

400

400

ASD-B2-0421-B			
ECMA-C20604□S ECMA-C20804□7 ECMA-CM0604PS			
3	5	3	5
ASDBCAPW0203	ASDBCAPW0205	ASDBCAPW0303	ASDBCAPW0305
ASDBCAEN0003	ASDBCAEN0005	ASDBCAEN0003	ASDBCAEN0005
ASDBCAPW0000		ASDBCAPW0100	
ASDBCAEN0000			

750

750

ASD-B2-0721-B			
ECMA-C20807□S ECMA-C20907□S			
3	5	3	5
ASDBCAPW0203	ASDBCAPW0205	ASDBCAPW0303	ASDBCAPW0305
ASDBCAEN0003	ASDBCAEN0005	ASDBCAEN0003	ASDBCAEN0005
ASDBCAPW0000		ASDBCAPW0100	
ASDBCAEN0000			



750

600

ASD-B2-0721-B			
ECMA-G21306□S ECMA-GM1306PS			
3	5	3	5
ASD-CAPW1203	ASD-CAPW1205	ASD-CAPW1303	ASD-CAPW1305
ASDBCAEN1003	ASDBCAEN1005	ASDBCAEN1003	ASDBCAEN1005
ASD-CAPW1000			
ASDBCAEN1000			

1

900

ASD-B2-1021-B			
ECMA-G21309□S ECMA-GM1309PS			
3	5	3	5
ASD-CAPW1203	ASD-CAPW1205	ASD-CAPW1303	ASD-CAPW1305
ASDBCAEN1003	ASDBCAEN1005	ASDBCAEN1003	ASDBCAEN1005
ASD-CAPW1000			
ASDBCAEN1000			

1

1

ASD-B2-1021-B			
ECMA-C21010□S ECMA-C20910□S			
3	5	3	5
ASD-CAPW1203	ASD-CAPW1205	ASD-CAPW1303	ASD-CAPW1305
ASDBCAEN1003	ASDBCAEN1005	ASDBCAEN1003	ASDBCAEN1005
ASDBCAPW1000			
ASDBCAEN1000			

1.5

1.5

ASD-B2-1521-B			
ECMA-E21315□S			
3	5	3	5
ASD-CAPW1203	ASD-CAPW1205	ASD-CAPW1303	ASD-CAPW1305
ASDBCAEN1003	ASDBCAEN1005	ASDBCAEN1003	ASDBCAEN1005
ASD-CAPW1000			
ASDBCAEN1000			

1

1

ASD-B2-1021-B			
ECMA-E21310□S			
3	5	3	5
ASD-CAPW1203	ASD-CAPW1205	ASD-CAPW1303	ASD-CAPW1305
ASDBCAEN1003	ASDBCAEN1005	ASDBCAEN1003	ASDBCAEN1005
ASD-CAPW1000			
ASDBCAEN1000			

2

2

ASD-B2-2023-B			
ECMA-C21020□S			
3	5	3	5
ASD-CAPW1203	ASD-CAPW1205	ASD-CAPW1303	ASD-CAPW1305
ASDBCAEN1003	ASDBCAEN1005	ASDBCAEN1003	ASDBCAEN1005
ASD-CAPW1000			
ASDBCAEN1000			



2

2

ASD-B2-2023-B			
ECMA-E21320□S			
3	5	3	5
ASD-CAPW1203	ASD-CAPW1205	ASD-CAPW1303	ASD-CAPW1305
ASDBCAEN1003	ASDBCAEN1005	ASDBCAEN1003	ASDBCAEN1005
ASD-CAPW1000			
ASDBCAEN1000			

ASD-B2-2023-B			
ECMA-E21820□S			
3	5	3	5
ASD-CAPW2203	ASD-CAPW2205	ASD-CAPW2303	ASD-CAPW2305
ASDBCAEN1003	ASDBCAEN1005	ASDBCAEN1003	ASDBCAEN1005
ASDBCAPW2000			
Разъемы энкодера ASDBCAEN1000			

3

3

ASD-B2-3023-B			
ECMA-E21830□S			
3	5	3	5
ASD-CAPW2203	ASD-CAPW2205	ASD-CAPW2303	ASD-CAPW2305
ASDBCAEN1003	ASDBCAEN1005	ASDBCAEN1003	ASDBCAEN1005
ASD-CAPW2000			
ASDBCAEN1000			

ASD-B2-3023-B			
ECMA-F21830□S			
3	5	3	5
ASD-CAPW2203	ASD-CAPW2205	ASD-CAPW2303	ASD-CAPW2305
ASDBCAEN1003	ASDBCAEN1005	ASDBCAEN1003	ASDBCAEN1005
ASDBCAPW2000			
ASDBCAEN1000			

